

Wire and Design Tools

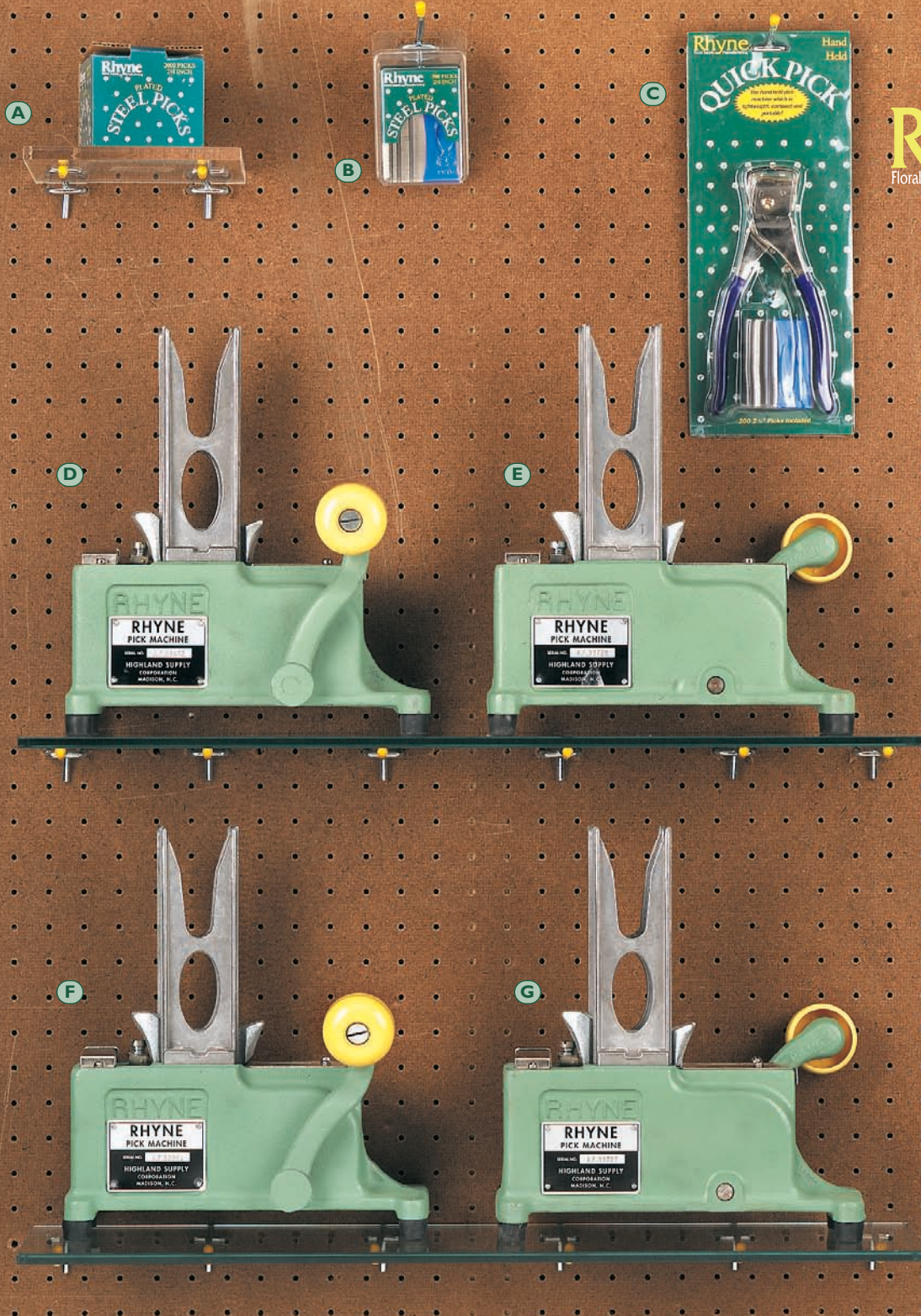



A) Rhyne Plated Steel Picks

Item Code	Size	Pack per Carton	Pick Count
PSPR-175	1 1/4"	6	12,000
PSPR-2125	2 1/8"	6	12,000
PSPR-3	3"	5	10,000

B) Rhyne Plated Steel Picks (Blister Packs)

Item Code	Size	Pack per Carton	Pick Count
PSPR-175B	1 1/4"	54	200/pack
PSPR-2125B	2 1/8"	54	200/pack
PSPR-3B	3"	54	200/pack

C) Rhyne Steel Pick Machine (Hand Held)

Item Code	Carton Pack
FSMRHH-GN	12

D) Rhyne Steel Pick Machine (Left Handed)

Item Code	Carton Pack
FSMRL-GN	1

E) Rhyne Steel Pick Machine (Right Handed)

Item Code	Carton Pack
FSMRR-GN	1

F) Rhyne Steel Pick Machine (tight-crimp, left handed) Recommended use - Silk

Item Code	Carton Pack
FSMRLTC-GN	1

G) Rhyne Steel Pick Machine (tight-crimp, right handed) Recommended use - Silk

Item Code	Carton Pack
FSMRTC-GN	1



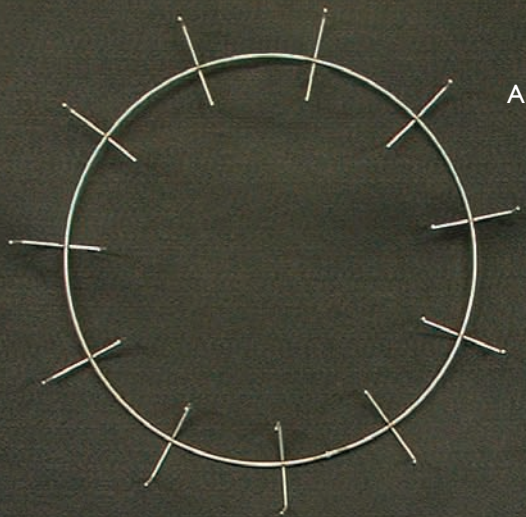

A

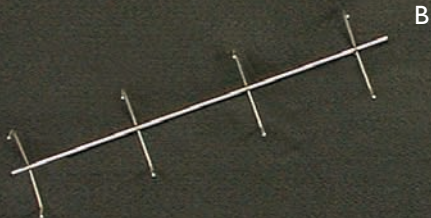

B

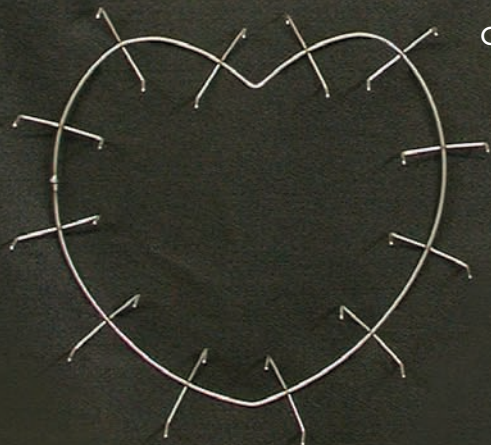

C

A) Rhyme Lockit Wire Rings

Item Code	Size	Number of Clips	Number Posts	Packs per Carton
LWR6	6"	5	0	100
LWR8	8"	8	0	100
LWR8P	8"	8	4	100
LWR8S	8"	8 (short)	0	100
LWR9	9"	9	0	100
LWR10	10"	9	0	100
LWR10P	10"	10	4	100
LWR12	12"	11	0	100
LWR14	14"	13	0	50
LWR16	16"	15	0	50
LWR18	18"	17	0	40
LWR20	20"	19	0	40
LWR20P	20"	19	4	100
LWR24	24"	23	0	40

B) Rhyme Lockit Wire Swags

Item Code	Size	Number of Clips	Number Posts	Packs per Carton
LWS3	3"	1	0	100
LWS7	7"	3	0	50
LWS9	9"	5	0	50
LWS9P	9"	5	2	100
LWS12	12"	4	0	25
LWS20	20"	7	0	25
LWS24	24"	8	0	25
LWS36	36"	12	0	25

C) Rhyme Lockit Wire Heart Rings

Item Code	Size	Number of Clips	Number Posts	Packs per Carton
LWR10H	10"	8	0	100
LWR12H	12"	12	0	100
LWR24H	24"	23	0	25

D) Rhyme Lockit Wire Ring Machine

Item Code	Carton Pack
LWM	1

Rhyme Lockit Wire Ring Machine (Parts)

Item Code	Description	Carton Pack
LWM-1	Cable	1
LWM-2	Return Spring	1



D



Rhyne Stemming Machines

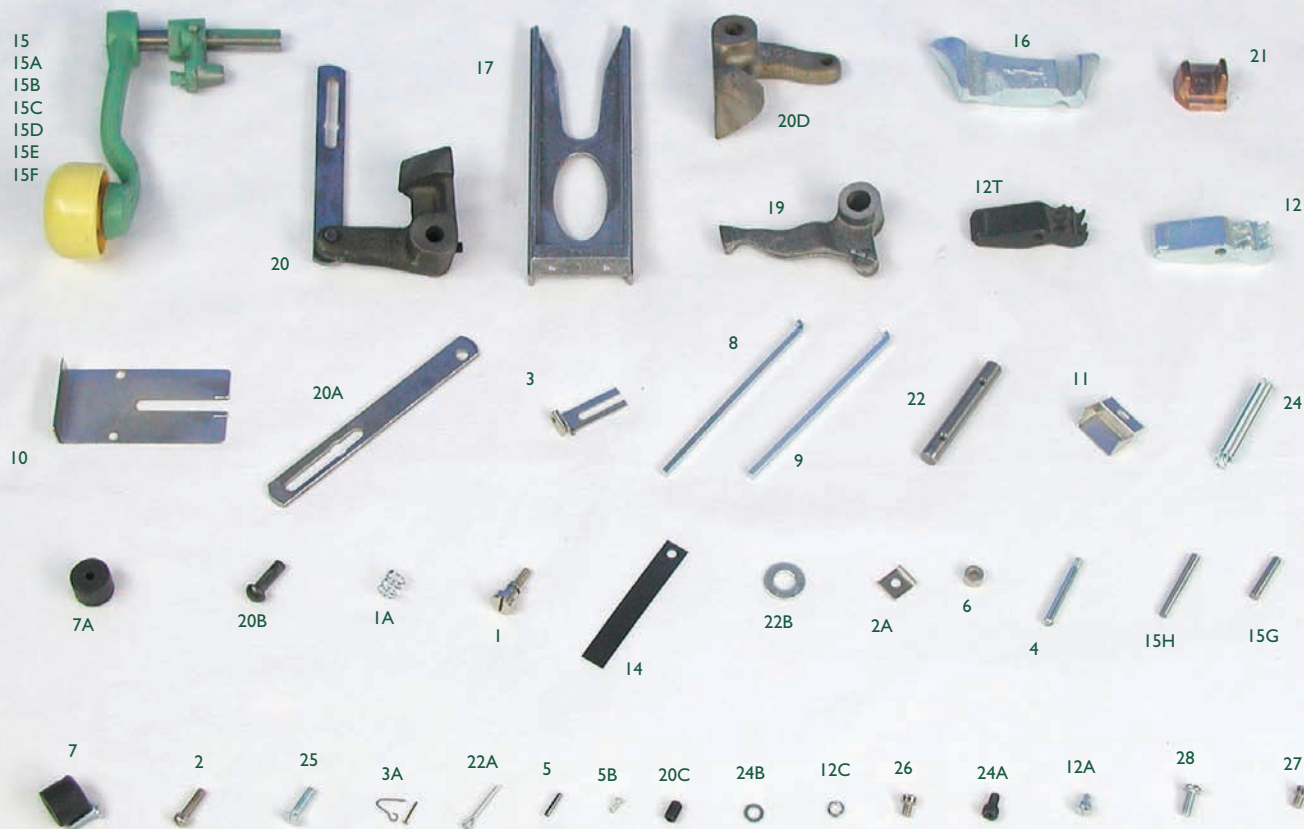

- | | | | |
|---------|--|---------|--|
| RMP-1 | Separator Adjustable Screw | RMP-15E | Knob for Pick Machine |
| RMP-1A | Spring – only | RMP-15F | Screw for Knob |
| RMP-2 | Separator Lock Screw | RMP-15G | #2 x 1" Taper Pin |
| RMP-2A | Square Lock Washer | RMP-15H | #2 x 1 1/2" Taper Pin |
| RMP-3 | Pick Separator and Spring | RMP-16 | Pick Weight |
| RMP-3A | Pick Separator Spring – Only | RMP-17 | Magazine Uprights |
| RMP-4 | Jaw Bearing Pin | RMP-19 | Push Rod Rocker Arm |
| RMP-5 | Spring Pin 3/32" x 1/2" | RMP-20 | CLO Wedge Assembly Bar (#4625 & Up) |
| RMP-5B | #2 x 1/4" Round "U" Drive Screw | RMP-20A | Bar Only (#4625 & Up) |
| RMP-6 | Pick Separator Collar | RMP-20B | Rivets for Wedge |
| RMP-7 | Rubber Feet with Screw | RMP-20C | Set Screw for Wedge |
| RMP-7A | Rubber Feet Only | RMP-20D | Wedge (only for #4625) |
| RMP-8 | Push Rod – Long | RMP-21 | Push Rod Carriage |
| RMP-9 | Push Rod – Short | RMP-22 | Wedge Shaft |
| RMP-10 | Push Rod Cover Plate | RMP-22A | Cotter Pin (3/32" x 3/4") |
| RMP-11 | Jaw Guards - Pair (two items per carton) | RMP-22B | 3/8" Flat Washer |
| RMP-12 | Jaw | RMP-24 | Push Rod Return Spring |
| RMP-12A | Jaw Spring Screw | RMP-24A | Screw for Return Spring |
| RMP-12C | #10 Lock Washer for Jaws | RMP-24B | #10 Flat Washer |
| RMP-12T | Jaw Tight Crimp | RMP-25 | Screws for Magazine Upright-Pair
(two items per carton) |
| RMP-14 | Jaw Spring – Long | RMP-26 | Screws for Jaw Covers (two items per carton) |
| RMP-15 | Handle Cam Shaft Knob | RMP-27 | Screws for Push Rod Cover
(two items per carton) |
| RMP-15A | Handle for Pick Machine | RMP-28 | Screws for Rubber Feet |
| RMP-15B | Shaft | | |
| RMP-15C | Cam | | |
| RMP-15D | Pin for Cam | | |



Green Enameled Florist Wire

Available in 12" or 18" lengths. Please replace the ★ with the desired length in the Item Code. (Packed 4, 12 lb. boxes per carton)

Gauge Size	Item Code	Carton Weight
16 Gauge	FW16★-GN	50 lb.
18 Gauge	FW18★-GN	50 lb.
19 Gauge	FW19★-GN	50 lb.
20 Gauge	FW20★-GN	50 lb.
21 Gauge	FW21★-GN	50 lb.
22 Gauge	FW22★-GN	50 lb.
23 Gauge	FW23★-GN	50 lb.
24 Gauge	FW24★-GN	50 lb.
26 Gauge	FW26★-GN	50 lb.
28 Gauge	FW28★-GN	50 lb.
30 Gauge	FW30★-GN	50 lb.

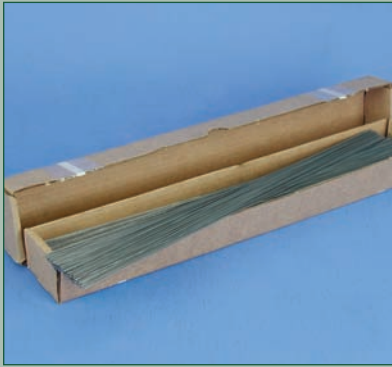

Bright Annealed Florist Wire

Available in 12" or 18" lengths. Please replace the ★ with the desired length in the Item Code. (Packed 4, 12 lb. boxes per carton)

Gauge Size	Item Code	Carton Weight
16 Gauge	FW16★-BRT	50 lb.
18 Gauge	FW18★-BRT	50 lb.
19 Gauge	FW19★-BRT	50 lb.
20 Gauge	FW20★-BRT	50 lb.
21 Gauge	FW21★-BRT	50 lb.
22 Gauge	FW22★-BRT	50 lb.
23 Gauge	FW23★-BRT	50 lb.
24 Gauge	FW24★-BRT	50 lb.
26 Gauge	FW26★-BRT	50 lb.
28 Gauge	FW28★-BRT	50 lb.
30 Gauge	FW30★-BRT	50 lb.



Green Enameled Spooled Wire

Spooled wire is packed 12 spools per 6 lb. box; 4, 6 lb. boxes per carton. Carton Gross Pack is 48.

Gauge Size	Item Code	Size	Carton Weight
20 Gauge	SPW20-GN	½ lb.	28 lb.
21 Gauge	SPW21-GN	½ lb.	28 lb.
22 Gauge	SPW22-GN	½ lb.	28 lb.
23 Gauge	SPW23-GN	½ lb.	28 lb.
24 Gauge	SPW24-GN	½ lb.	28 lb.
26 Gauge	SPW26-GN	½ lb.	28 lb.
28 Gauge	SPW28-GN	½ lb.	28 lb.
30 Gauge	SPW30-GN	½ lb.	28 lb.



Bright Annealed Spooled Wire

Spooled wire is packed 12 spools per 6 lb. box; 4, 6 lb. boxes per carton. Carton Gross Pack is 48.

Gauge Size	Item Code	Size	Carton Weight
20 Gauge	SPW20-BRT	½ lb.	28 lb.
21 Gauge	SPW21-BRT	½ lb.	28 lb.
22 Gauge	SPW22-BRT	½ lb.	28 lb.
23 Gauge	SPW23-BRT	½ lb.	28 lb.
24 Gauge	SPW24-BRT	½ lb.	28 lb.
26 Gauge	SPW26-BRT	½ lb.	28 lb.
28 Gauge	SPW28-BRT	½ lb.	28 lb.
30 Gauge	SPW30-BRT	½ lb.	28 lb.

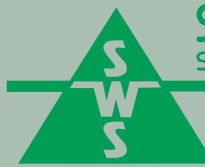

Green Enameled Paddle Wire

Paddle wire is packed 20 paddles per 5 lb. box; 4, 5 lb. boxes per carton. Carton Gross pack is 80.

Gauge Size	Item Code	Size	Carton Weight
20 Gauge	PW20-GN/4	¼ lb.	24 lb.
22 Gauge	PW22-GN/4	¼ lb.	24 lb.
24 Gauge	PW24-GN/4	¼ lb.	24 lb.
26 Gauge	PW26-GN/4	¼ lb.	24 lb.
28 Gauge	PW28-GN/4	¼ lb.	24 lb.
30 Gauge	PW30-GN/4	¼ lb.	24 lb.



Bright Annealed Paddle Wire

Paddle wire is packed 20 paddles per 5 lb. box; 4, 5 lb. boxes per carton. Carton Gross pack is 80.

Gauge Size	Item Code	Size	Carton Weight
20 Gauge	PW20-BRT/4	¼ lb.	24 lb.
22 Gauge	PW22-BRT/4	¼ lb.	24 lb.
24 Gauge	PW24-BRT/4	¼ lb.	24 lb.
26 Gauge	PW26-BRT/4	¼ lb.	24 lb.
28 Gauge	PW28-BRT/4	¼ lb.	24 lb.
30 Gauge	PW30-BRT/4	¼ lb.	24 lb.

A) Poinsettia Stakes (Green Painted)

Item Code	Gauge	Stake Size	Carton Pack	Carton Weight
PS18-GN	14	18"	1000	26 lb.
PS24-GN	14	24"	1000	34 lb.

B) Soft Florist Netting

Item Code	Netting Type	Wire Size	Roll Size	Carton Weight
FN12-GN	Green	12"	150'	13 lb.
FN18-GN	Green	18"	150'	19 lb.
FN12-BRT	Galvanized	12"	150'	13 lb.
FN18-BRT	Galvanized	18"	150'	19 lb.

C) Green Enameled Florist Wire (1 lb. packs)

Gauge Size	Item Code	Size	Carton Pack	Carton Weight
16	FW1618LB-GN	18"	20 each, 1 lb. bag	20 lb.
18	FW1818LB-GN	18"	20 each, 1 lb. bag	20 lb.
19	FW1918LB-GN	18"	20 each, 1 lb. bag	20 lb.
20	FW2018LB-GN	18"	20 each, 1 lb. bag	20 lb.
21	FW2118LB-GN	18"	20 each, 1 lb. bag	20 lb.
22	FW2218LB-GN	18"	20 each, 1 lb. bag	20 lb.
23	FW2318LB-GN	18"	20 each, 1 lb. bag	20 lb.
24	FW2418LB-GN	18"	20 each, 1 lb. bag	20 lb.
26	FW2618LB-GN	18"	20 each, 1 lb. bag	20 lb.

D) Galvanized Pot Stakes

Item Code	Gauge	Stake Size	Carton Pack	Carton Weight
GPS14-GLV	10	14"	200	13 lb.





Monument Stone Plaques (Aluminum)

Monument stone plaques are recommended for outdoor use.

Item Code	Size	Carton Pack	Carton Weight
SP8-ALM	8"	50	16 lb.
SP13-ALM	13"	25	12 lb.
SP16-ALM	16"	25	13 lb.



Monument Stone Plaques (Galvanized)

Monument stone plaques are recommended for outdoor use.

Item Code	Size	Carton Pack	Carton Weight
SP8-GLV	8"	100	33 lb.
SP12-GLV	12"	50	23 lb.



Casket Plaques (Green Painted)

Casket plaques are NOT recommended for outdoor use.

Item Code	Size	Carton Pack	Carton Weight
CP12-GN	12"	50	27 lb.
CP18-GN	18"	50	32 lb.
CP24-GN	24"	25	20 lb.
CP30-GN	30"	25	23 lb.
CP36-GN	36"	25	27 lb.
CP42-GN	42"	25	34 lb.
CP48-GN	48"	25	34 lb.

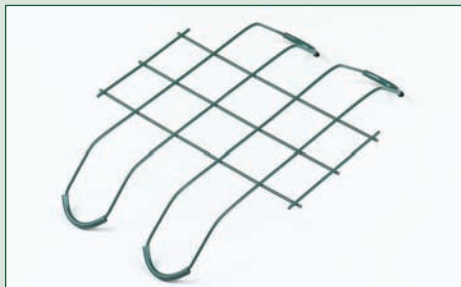

Flat End Casket Plaques (Green Painted)

Monument stone plaques are NOT recommended for outdoor use.

Item Code	Size	Carton Pack	Carton Weight
CPS12-GN	12"	50	27 lb.
CPS18-GN	18"	50	32 lb.

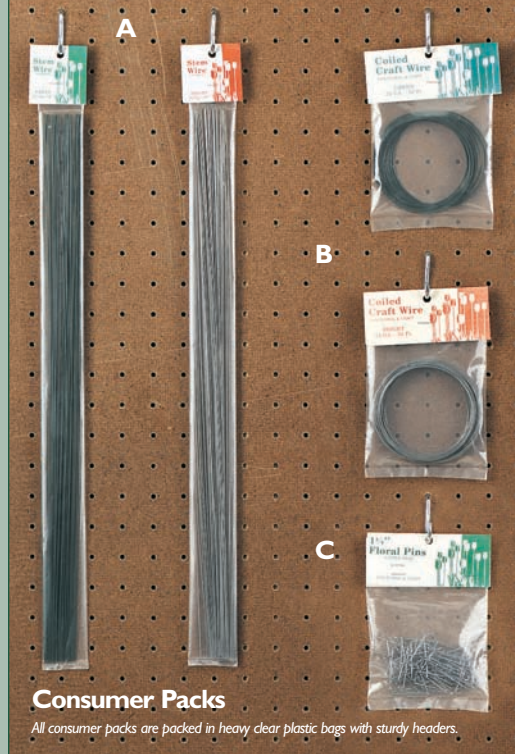

Consumer Packs

All consumer packs are packed in heavy clear plastic bags with sturdy headers.

A) Straightened and Cut Craft Wire

Available in Green (GN) and Bright (BRT) finishes. Please substitute for ★ in item code. Packed 50 bags per box; four boxes per carton.

Item Code	Gauge Size	Bag Count	Carton Pack
CW1618-★	16	16	200
CW1818-★	18	25	200
CW2018-★	20	40	200
CW2118-★	21	40	200
CW2218-★	22	50	200
CW2418-★	24	50	200
CW2618-★	26	60	200
CW2818-★	28	60	200
CW3018-★	30	70	200

B) Coiled Craft Wire

Available in Green (GN) and Bright (BRT) finishes. Please substitute for ★ in item code.

Item Code	Size	Carton Pack	Carton Weight
CCW24-★	50'	50	5 lb.

C) Craft and Floral Pins (S-Type)

Packed approximately 50 pins per bag; 50 bags per carton.

Item Code	Size	Carton Pack	Carton Weight
CWP125-I	1/4"	50	5 lb.
CWP175-I	1/4"	50	6 lb.



Bright Finish Greening Pins

1 1/2" S-Type

Item Code	Size	Carton Weight
GPI75-5	5 lb.	6 lb.
GPI75-10	10 lb.	11 lb.
GPI75-25	25 lb.	27 lb.

Special 1/4" S-Type

Item Code	Size	Carton Weight
GPI25-5	5 lb.	6 lb.
GPI25-10	10 lb.	11 lb.
GPI25-25	25 lb.	27 lb.



Mass Market Packs

Pins are packed in 2 lb. boxes; 12 boxes per carton. Florist wire is packed in four pound tubes; eight tubes per carton.

Item Description	Item Code	Size	Carton Pack	Carton Weight
Fern/Greening Pins (S-Type)	GPI75-24	1 1/2"	12	28 lb.
Green Florist Wire	FWM1618-GN	16 Gauge	8	34 lb.
	FWM1818-GN	18 Gauge	8	34 lb.
	FWM2018-GN	20 Gauge	8	34 lb.
	FWM2118-GN	21 Gauge	8	34 lb.
	FWM2218-GN	22 Gauge	8	34 lb.
	FWM2318-GN	23 Gauge	8	34 lb.
	FWM2418-GN	24 Gauge	8	34 lb.
	FWM2618-GN	26 Gauge	8	34 lb.
	FWM2818-GN	28 Gauge	8	34 lb.
	FWM3018-GN	30 Gauge	8	34 lb.



Green Painted Standard Wire Easels

Easels are packed in bundles of five. All easels are packaged in sturdy corrugated cartons for protection in transit.

Item Code	Size	Carton Pack	Carton Weight
WE18-GN/25	18"	25	6 lb.
WE21-GN/25	21"	25	8 lb.
WE24-GN/25	24"	25	11 lb.
WE27-GN/25	27"	25	12 lb.
WE30-GN/25	30"	25	17 lb.
WE33-GN/25	33"	25	23 lb.
WE36-GN/25	36"	25	27 lb.
WE42-GN/25	42"	25	37 lb.
WE48-GN/25	48"	25	47 lb.
WE54-GN/25	54"	25	59 lb.
WE60-GN/25	60"	25	75 lb.
WE66-GN/15	66"	15	64 lb.
WE72-GN/15	72"	15	77 lb.





Plated Steel Picks

Item Code	Size Inches (CM)	Boxes per Carton	Pick Count Inner Box	Pick Count Master Carton
PSP-175	1 3/8" (4.5)	6	2000	12,000
PSP-2125	2 1/2" (5.5)	6	2000	12,000
PSP-3	3" (7.5)	5	2000	10,000
PSP-45	4 1/2" (11.5)	3	2000	6000

Consumer Packs

PSP-2125/R	2 1/2" (5.5)	36	300 50/pack	10,800 36 packs	8.5 lb.	24 lb.
------------	--------------	----	----------------	--------------------	---------	--------



Foliage Steel Picks

Item Code	Size Inches (CM)	Boxes per Carton	Pick Count Inner Box	Pick Count Master Carton
FSP-2125	2 1/2" (5.5)	6	1600	9600
FSP-3	3" (7.5)	5	1600	8000
FSP-45	4 1/2" (11.5)	3	1600	4800



Black Floral Stemming Machine

Item Code	Carton Pack	Carton Weight
FSM-BL	1	14 lb.



Green Floral Stemming Machine

Item Code	Carton Pack	Carton Weight
FSM-GN	1	14 lb.



Semi-Automatic Floral Stemming Machine (Pneumatic with adjuster)

Item Code	Carton Pack	Carton Weight
FSM-SA	1	23 lb.



Foliage Pick Machine

Item Code	Carton Pack	Carton Weight
FSM-FF (Flat Springs)	1	14 lb.
FSM-CF (Coil Springs)	1	14 lb.



Picklicator™ (in Consumer Pack)

Item Code	Carton Pack	Carton Weight
FSM-PL	6	12 lb.



Replacement Parts for B&K Stemming Machines

Replacement parts are available from B&K. For listings, please see page ???.



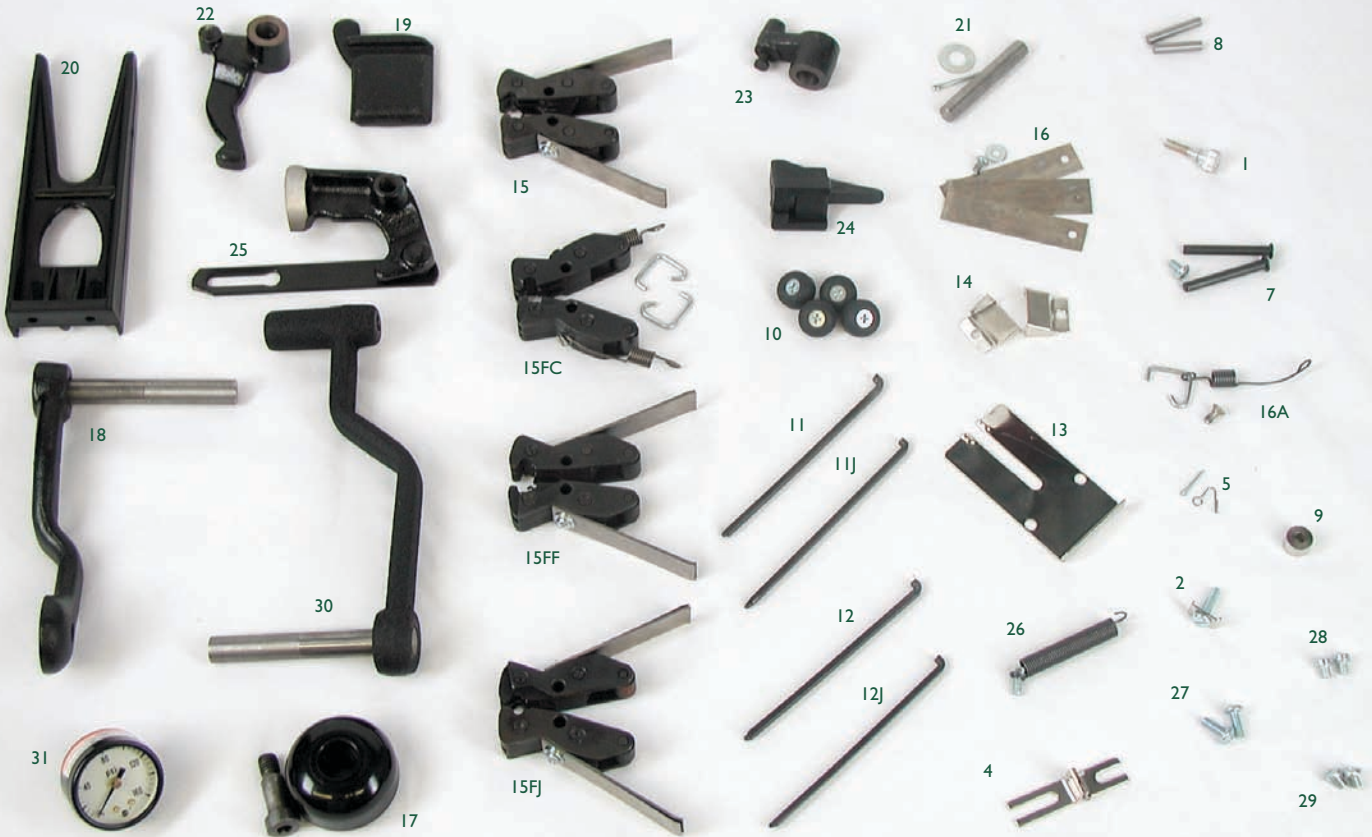

- BK-1 Separator Adjusting Screw
- BK-2 Separator lock screw $\frac{1}{32}'' \times \frac{3}{4}''$; pin head slot; separator washer
- BK-4 Pick separator (new type); spring & rivet
- BK-5 Pick separator; spring & rivet
- BK-7 (2) Jaw bearing pins (new type); holder screw $\frac{1}{2}'' \times \frac{3}{8}''$; truss slotted head screw - slotted
- BK-8 Shaft pin 3'' x 1'' (inside of machine) or shaft pin 3'' x 1 1/4'' (for handle)**
- BK-9 Pick separator collar
- BK-10 (4) rubber fee with (4) rubber screws; $\frac{1}{32}'' \times \frac{1}{2}''$ flat head or oval phillips head
- BK-11 Push rod – long**
- BK-11J Push rod – long; Japanese Type**
- BK-12 Push rod – short**
- BK-12J Push rod – short; Japanese Type**
- BK-13 Push rod cover plate; (2) screw $\frac{1}{32}'' \times \frac{1}{4}''$ -pan head phillips. See BK-29 for replacement screws only.
- BK-14 Jaw guards (2 per machine); 1 screw $\frac{1}{32}'' \times \frac{1}{4}''$. See BK-28 for replacement screws only.
- BK-15 Jaws left & right; 4 springs-flat; 1 washer; 1 screw $\frac{1}{32}'' \times \frac{1}{4}''$ round head/screw slotted**
- BK-15FC Foliage jaws left & right; coil springs; screw $\frac{3}{32}'' \times \frac{1}{4}''$ flat head/slotted; hooks .815 x .930
- BK-15FF Foliage jaws left & right; 4 springs flat; washer; screw $\frac{3}{32}'' \times \frac{1}{4}''$ flat head/slotted
- BK-15J Jaws (Japanese Type)
- BK-16 4 Jaw springs flat; washer; screw $\frac{1}{32}'' \times \frac{1}{4}''$ slotted round head screw
- BK-16A Jaw spring (new coil); hook .815 x .930, screw $\frac{3}{32}'' \times \frac{3}{8}''$ flat head screw slotted
- BK-17 Knob, scrw 8/8 - $\frac{3}{16}'' \times 1 \frac{1}{4}''$ special shoulder
- BK-18SB Handle & shaft assembly. Black single handle
- BK-19 Pick Weight
- BK-20 Magazine upright-nylon; (2) screws $\frac{1}{32}'' \times \frac{1}{2}''$ pan head screw. See BK-27 for replacement screws only.
- BK-21 Rocker arm shaft; cotter pin $\frac{3}{32}'' \times 1''$ & washer
- BK-22 Push rod rocker arm & cotter pin $\frac{3}{32}'' \times 1''$
- BK-23 Wedge assembly cam & steel pin
- BK-24 Push rod carriage**
- BK-25 Closing wedge assembly; heavy duty cam bar; screws $\frac{5}{16}'' \times 18'' \times \frac{3}{8}''$
- BK-26 Push rod return spring; screw $\frac{1}{32}'' \times \frac{1}{2}''$ flat head phillip
- BK-27 (2) $\frac{1}{32}'' \times \frac{1}{2}''$ pan head phillip screws for magazine uprights
- BK-28 (2) $\frac{1}{32}'' \times \frac{1}{2}''$ pan head phillips screws for jaw cover
- BK-29 (2) $\frac{1}{32}'' \times \frac{1}{4}''$ pan head phillips screws for push rod cover
- BK-30 New handle
- BK-31 Air gauge**

Bolded items in italics: HSC recommends factory fitting when ordering parts; please specify serial number of machine.

